

Universal Mid End Clamp

Integrated and simplified
universal mid and end
clamp.



Universal Mid/End clamp used to secure solar modules to array.
Can clamp modules 30 to 50 mm thick.

Part No.: **GR-ME-UNV-BLK**
Weight (lbs): **0.147**
Dim (in): **13.5 x 10.5 x 4.5**
Materials Used: **300 Series Stainless Steel**

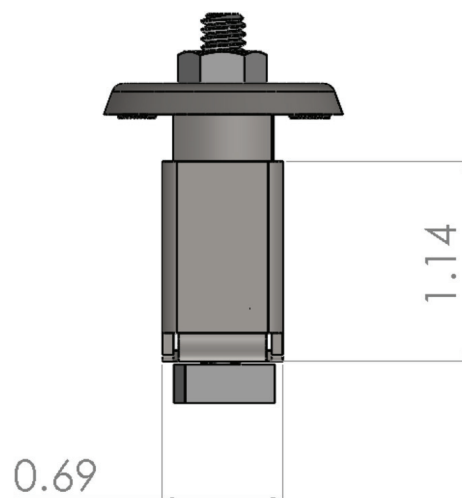
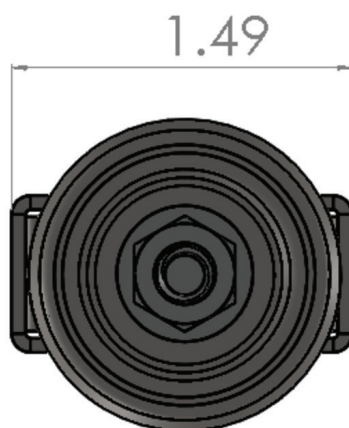
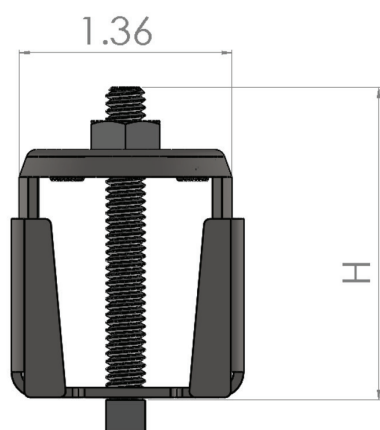

QRC CODE
HERE